

IBV series vacuum ball valves



Ball valves are popular in applications where fast action and full bore pumping are needed. The Edwards IBV series valves combine these practical everyday features plus ease of use and economy in a high specification design. Manufactured in 316L stainless steel with PTFE seats they deliver robust performance in a wide variety of vacuum duties.

Features & Benefits

- Low capital cost
- Convenient NW16, 25, 40, 50 sizes
- Optional BSP threaded versions
- Easy to use manual operation
- High conductance full bore pumping

5

Page
168

Dimensions

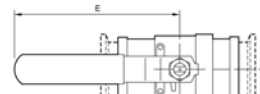
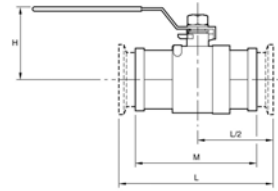

MODEL	E	H	L	M	FLANGE
IBV16MKS	120	56	92.5	-	NW10/16
IBV16MS	120	56	-	59.7	1/2" BSP
IBV25MKS	148	70	118.5	-	NW25
IBV25MS	148	70	-	82.5	1" BSP
IBV40MKS	164	84	166.5	-	NW40
IBV40MS	164	84	-	111	1 1/2" BSP
IBV50MKS	164	94	175.5	-	NW50
IBV50MS	164	94	-	125	2" BSP

Technical Data

Construction materials	
Body	AISI 316L stainless steel
Ball	AISI 316L stainless steel
Cups	PTFE
Leak rate	1×10^{-6} mbar ls ⁻¹ / 8×10^{-7} Torr ls ⁻¹
Molecular conductance	
IBV16MKS	5.3 ls ⁻¹
IBV25MKS	15.9 ls ⁻¹
IBV40MKS	46.5 ls ⁻¹
IBV50MKS	86.0 ls ⁻¹
Pressure rating (bar absolute) using NW Co-Seal	7 bar / 102 psi
Ambient operating temp range	5 to 65 °C
Reliability MTTF	30000 cycles
Weight (g/lbs)	
IBV16MKS (MS)	1200 / 2.6 (750 / 1.7)
IBV25MKS (MS)	1750 / 3.9 (1500 / 3.3)
IBV40MKS (MS)	3100 / 6.8 (2600 / 5.7)
IBV50MKS (MS)	4300 / 9.4 (3600 / 7.9)

Ordering Information

Product Description	Order No.
IBV16MKS Ball Valve NW16	C36000100
IBV16MS Ball Valve 1/2" BSP	C36000110
IBV25MKS Ball Valve NW25	C36000200
IBV25MS Ball Valve 1" BSP	C36000210
IBV40MKS Ball Valve NW40	C36000300
IBV40MS Ball Valve 1.1/2" BSP	C36000310
IBV50MKS Ball Valve NW50	C36000400
IBV50MS Ball Valve 2" BSP	C36000410