



PRODUCT DATA

XDS-C Dry Pump for Wet Chemistry

CHEMICALLY RESISTANT COMPLETELY DRY, LUBRICANT-FREE VACUUM PUMP

The versatile XDS-C uses a scroll mechanism and is manufactured by BOC Edwards, the market leader in dry pumping products and technology. Innovative XDS-C series dry pumps were designed by BOC Edwards to provide vacuum totally free of lubricants. The bearings are isolated from the vacuum environment by the patented XDS-C bearing shield. Uniquely, there are no bearings, grease or oil under vacuum and no bearing purge. Controllable gas ballast is standard and makes the XDS-C suitable for pumping condensable vapors. A carefully selected and tested combination of chemically resistant materials makes the XDS-C series ideal for a wide range of laboratory wet chemistry applications. With no oil to change, low vibration and noise levels, and high pump speeds from a compact package, the XDS-C is the ideal laboratory pump.

Features & Benefits

- Totally dry, lubricant-free vacuum
 - No oils or greases of any kind
 - Cleaner, more repeatable processes
 - No bearings or shaft seals in the pumping volume
 - No bearings to purge
- Two models
 - XDS5-C - $6 \text{ m}^3 \text{ h}^{-1}$ (3.5 cfm) @60 Hz
 - XDS10-C - $11 \text{ m}^3 \text{ h}^{-1}$ (6.5 cfm) @60 Hz
- Ultimate 0.9 mbar (0.675 torr)
- Ease of maintenance
 - No oil to buy, change or dispose of
 - No re-greasing of bearings
 - No special tools, shims or jigs needed for service
 - Simple supply voltage selection
- 3-position gas ballast selector
 - Pumps in excess of 200 gh^{-1} water vapor

TECHNICAL DATA

SPECIFICATIONS

	XDS5-C	XDS10-C		XDS5-C & XDS10-C
• Displacement (swept volume)	5.7 m ³ h ⁻¹ (3.4 cfm)	11.3 m ³ h ⁻¹ (6.7 cfm)	• Motor Supply Voltage	110 V or 220 - 240 V
	6.7 m ³ h ⁻¹ (4.0 cfm)	13.4 m ³ h ⁻¹ (7.9 cfm)		115 - 120 V or 230 - 240 V
• Pneurop pumping speed	4.8 m ³ h ⁻¹ (2.8 cfm)	9.3 m ³ h ⁻¹ (5.5 cfm)	50 Hz 1 phase	200 - 220 V or 380 - 415 V
	6.0 m ³ h ⁻¹ (3.5 cfm)	11.1 m ³ h ⁻¹ (6.5 cfm)	60 Hz 1 phase	200 - 230 V or 460 V
• Ultimate vacuum (total pressure)	0.9 mbar (0.675 torr)	0.9 mbar (0.675 torr)	50 Hz 3 phase	0.3 kW
• Exhaust connection	DN25NW	DN25NW	60 Hz 3 phase	
• Mass	23 kg (51 lb)	24.5 kg (54 lb)	• Power	DN25NW DN25NW
			• Inlet connection	+10°C to 40°C (+50°F to 104°F)
			• Operating temperature	-30°C to 70°C (-22°F to 158°F)
			• Storage temperature	55 dB(A)
			• Noise level @ ultimate (at 1 metre)	
			• Vibration	<1.5 mms ⁻¹ (rms)
			• Leak tightness (static)	<10 ⁻⁶ mbar ^l s ⁻¹ (<7.5x10 ⁻⁷ torrls ⁻¹)
			• Water vapor handling (GB1 flow)	70 gh ⁻¹
			• Water vapor handling (GB2 flow)	>200 gh ⁻¹

PUMPING SPEED CURVES

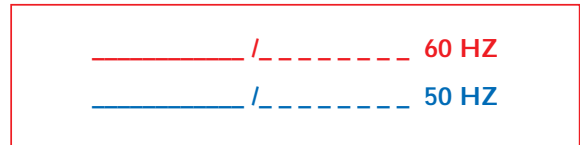
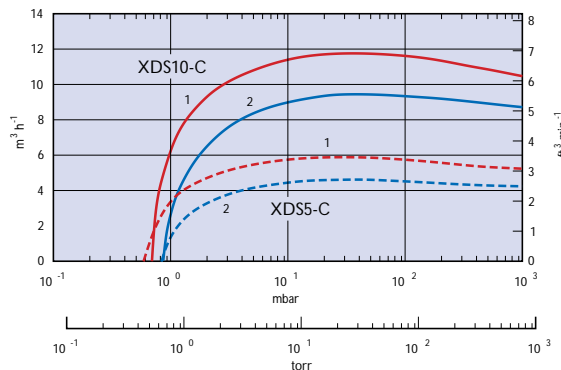

DIMENSIONS

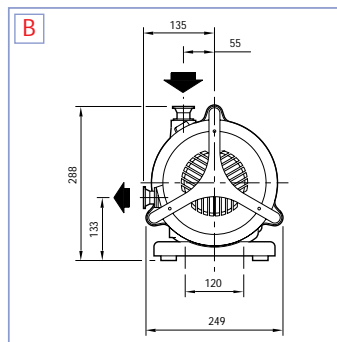
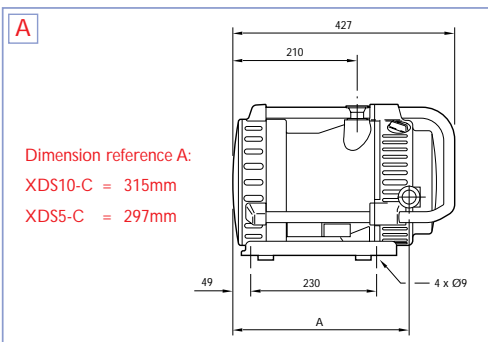

ORDERING INFORMATION

PRODUCT DESCRIPTION	ORDERING INFORMATION	PRODUCT DESCRIPTION	ORDERING INFORMATION
XDS5-C		XDS10-C	
1 phase	A725-01-906	1 phase	A727-01-906
3 phase	A725-01-905	3 phase	A727-01-905

EUROPE
Crawley, UK +(44) 1293 528844
Guildford, UK +(44) 1483 579857
Cumbemauld, UK +(44) 1236 730575
Brussels, BELGIUM +(32) 2 363 0030
Paris, FRANCE +(33) 1 47 98 24 01
Munich, GERMANY +(49) 89 99 19 18 0
Milan, ITALY +(39) 2 48 4471

ISRAEL
Qiryat Gat +(972) 7 681 0633

USA
Wilmington, MA +(1) 978 658 5410
Toll free (USA only) 1800 848 9800
Santa Clara, CA +(1) 408 496 1177
Tempe, AZ +(1) 480 777 7007
Austin, TX +(1) 512 491 6622

ASIA PACIFIC
Hong Kong +(852) 2796 9111
Shanghai, CHINA +(86) 21 5866 7558
Tianjin, CHINA +(86) 22 2834 1981
Toufen Town, TAIWAN R.O.C. +(886) 37 611 422
Singapore +(65) 546 8408

KOREA
Bundang +(82) 31 716 7070

JAPAN
Tokyo (Vacuum/Abatement) +(81) 3 5470 6530
Tokyo (Electronic Gases) +(81) 3 3434 6789
Osaka +(81) 6 384 7052
Kyushu +(81) 96 326 7300
Sendai +(81) 22 373 8525

<http://www.bocedwards.com>
Publication No: A726-03-895

BOC Edwards is a trading name used by affiliate companies of The BOC Group plc. The stripe symbol is a trademark of The BOC Group plc © BOC Edwards 2000

BOC EDWARDS