

# IPVA10EK Air Admit Valve

The IPVA10EK is a solenoid operated valve designed for automatic admittance of air or vent gas into a vacuum system. The valve has two ports with NW flanges. One of the valve ports is connected to the vacuum system, the other port can be left open to atmosphere or connected to a vent gas supply. The vacuum system is isolated from atmosphere (or the vent gas supply) by a fluoroelastomer pad on the base of the valve plunger, which seals against the body of the valve.



## Features & Benefits

- Normally open or normally closed option.
- Small envelope
- IP65 protection
- MTTF 100000 Cycles

## Dimensions

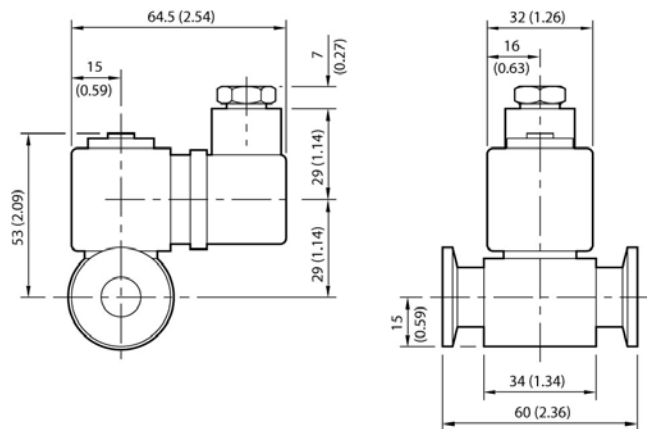

## Technical Data

Operating temperature range	-20 to 55 °C
Vent gas temperature range	-10 to 130 °C
Venting rate	10 litres in 12 s
Response time	30 ms
Maximum cycle frequency	100 min <sup>-1</sup>
Reliability (MTTF)	10 <sup>5</sup> cycles
Leak rate	1 x 10 <sup>-9</sup> mbar ls <sup>-1</sup> / 8 x 10 <sup>-10</sup> Torr ls <sup>-1</sup>
Electrical supply	110V or 240V a.c. 1-ph, 50/60 Hz or 24V d.c.
Tolerance	
a.c.	-10% to +10%
d.c.	-5% to +10%
Power	
a.c.	9.3 VA inrush 6.3 VA hold
d.c.	5W
Enclosure rating	IP65
Weight	310 g / 11 oz
Materials of construction	
Body	Aluminium
Valve seal	Fluoroelastomer
Actuator	Stainless steel
Coil insulation	Class F

The air or vent gas path through the valve is free from heavy metals.

## Ordering Information

Product Description	Order No.
IPVA10EK, 240 V a.c. (normally open)	C41721000
IPVA10EK, 110 V a.c. (normally open)	C41722000
IPVA10EK, 24 V d.c. (normally open)	C41723000
IPVA10EK, 240 V a.c. (normally closed)	C41731000
IPVA10EK, 110 V a.c. (normally closed)	C41732000
IPVA10EK, 24 V d.c. (normally closed)	C41733000